

## BOX PLANTERS

### OPTIONS:

- Available in H3 & M3 finish (see attached colour chart)
- Custom colour available upon request

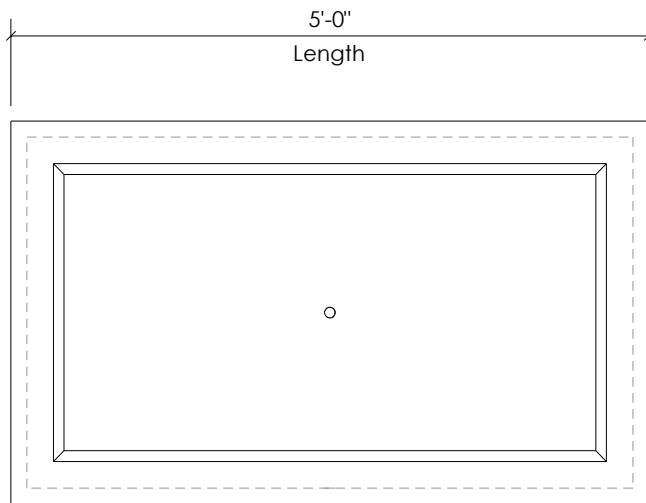

TOP VIEW

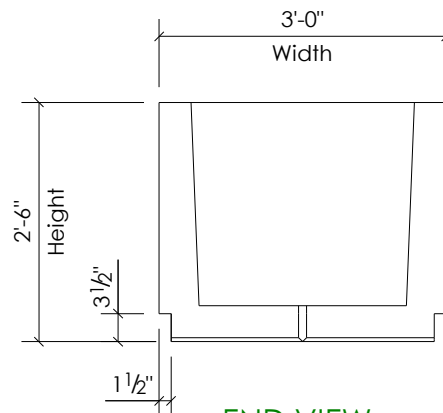

END VIEW

### AVAILABLE SIZES

part no.	length	width	height	weight
BP - 1	2'-0"	2'-0"	2'-0"	780 lbs
BP - 2	3'-0"	3'-0"	2'-6"	1700 lbs
BP - 3	4'-0"	2'-0"	2'-0"	1345 lbs
BP - 4	5'-0"	3'-0"	2'-6"	2490 lbs

Available with or without bottom cast in. Weights are approximate only.



326 Hardscratch Road  
 RR#4 Box 5618  
 Yarmouth, Nova Scotia  
 B5A 4A8

Ph: (902)742-7811  
 Fax: (902)742-7127  
 www.borcherdtconcrete.com  
 Email: info@borcherdtconcrete.com

Rev 0 May 2014

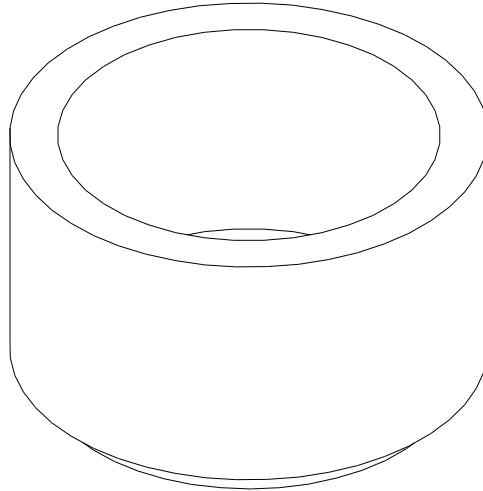

## ROUND PLANTERS

### OPTIONS:

- Available in H3 & M3 finish (see attached colour chart)
- Custom colour upon request

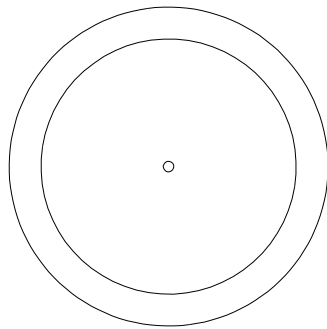

TOP VIEW

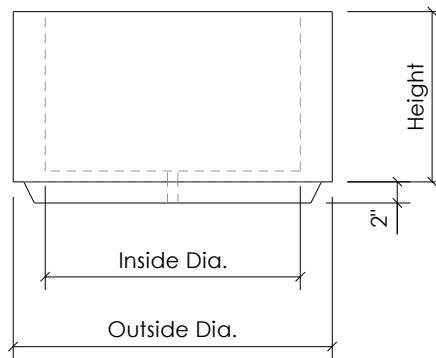

SIDE VIEW

### AVAILABLE SIZES

<u>part no.</u>	<u>O.D.</u>	<u>I.D.</u>	<u>height</u>	<u>weight</u>
PL2430	30"	24"	30"	785 lbs
PL2424	30"	24"	24"	650 lbs
PL2418	30"	24"	18"	510 lbs
PL2412	30"	24"	12"	370 lbs
PL3636	42"	36"	36"	1435 lbs
PL3630	42"	36"	30"	1235 lbs
PL3624	42"	36"	24"	1035 lbs
PL3618	42"	36"	18"	840 lbs
PL3612	42"	36"	12"	640 lbs
PL4236	51"	42"	36"	2465 lbs
PL4230	51"	42"	30"	2110 lbs
PL4224	51"	42"	24"	1755 lbs

Available with or without bottom cast in. Weights are approximate only.